



TRAIL FOR CHILDREN

THE COLLEGIATE CHURCH OF THE HOLY AND UNDIVIDED TRINITY,
Old Town, Stratford-upon-Avon, CV37 6BG

Explanatory notes and answers are available for accompanying adults



YOUR NAME

YOUR AGE

Follow the arrows on the plan and answer the questions 1-11

1 FONT



What is put in the font for Christian baptisms?

Why?

2 EAGLE LECTERN

What is it made of ?

marble stone brass

The B _ _ _ _ _

is placed on the lectern during services

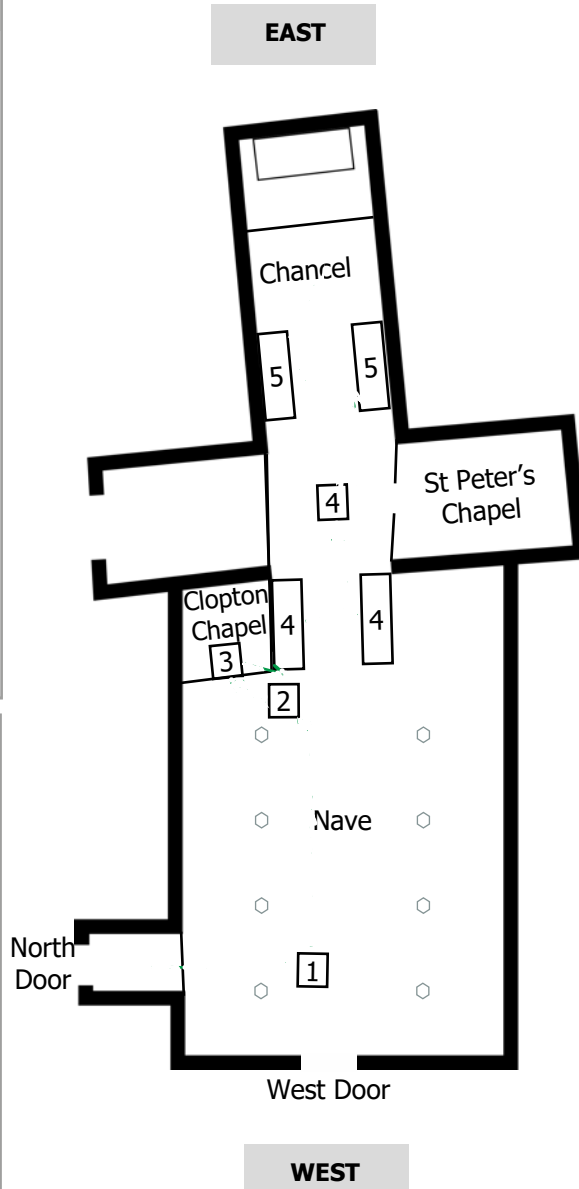

4 CHOIR STALLS

Find a cushion with a picture of the church. When was this church founded?

Now walk forward and look up at the ceiling. What bird is at the top of the chandelier?

robin

dove

swan

5 THE CHANCEL

Misericords are wooden seats for monks to rest on. Find a misericord with three carved faces and copy a face here.

3 CLOPTON CHAPEL

On the stone frieze high on the left hand wall, how many of the seven children are in swaddling clothes?



Here are 3 Clopton family coats of Arms. What happens to a coat of Arms when two families unite through marriage?

Look at the tomb of George Carew in front of you. He guarded Military supplies for James I. How do you know this by looking at the tomb?



6 SHAKESPEARE'S GRAVE

Shakespeare's bust is on the left hand wall. What is he holding in each hand?

_____ & _____

What are the dates of his birth and death? _____

Fill in the missing words from his gravestone:

Good _____ for Jesus' sake, forbear,

To _____ the dust enclosed here

_____ be the man who spares these _____,

And curst be he that _____ my _____

Can you name a play by Shakespeare? _____



7 HIGH ALTAR

This is the most Holy part of the Church.

Mark an **A** on your plan for the altar.

8 ST PETER'S CHAPEL

Spot the special candle which is always burning. Jesus once said

"I am the L _ _ _ T of the world."

On the diamond-shaped memorial plaque on the wall, who is "full of good works and alms deeds which she did"?

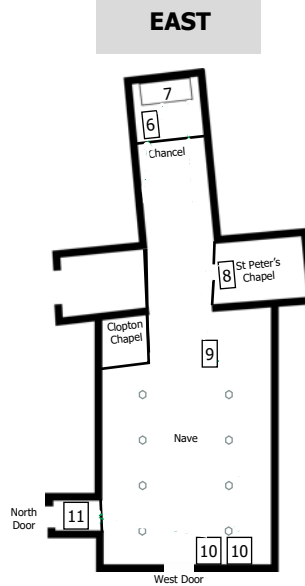

9 PULPIT



How many saints are carved around the sides of the pulpit? _____

Can you guess why the pulpit is so high?

10 WEST END

In this stained glass window, what is St George doing in the bottom left hand corner?

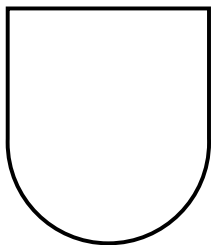

Complete the shield of St George.



There is a Victorian oil painting of the church on the back wall next to this window. Spot 5 differences between this picture and the church now.

- 1 _____
- 2 _____
- 3 _____
- 4 _____
- 5 _____

11 NORTH PORCH

Going out through the north porch, look back at the wooden door. Complete this drawing of the 13th century sanctuary knocker.

